

MEDIA KIT

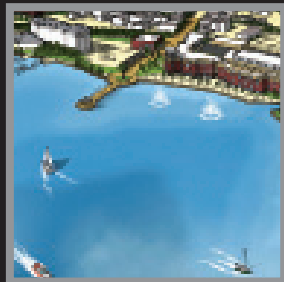

Company Profile

Business Highlights & Facts

Experts



project photo



project photo



project photo



project photo

When you hire Bergmann Associates, you're hiring our people. As a result, you'll get our passion, our expertise and our outstanding service, on each and every project.

Bergmann Associates represents three decades of culture built upon the work of our dedicated, client focused experts. Your Bergmann team will deliver what we promise, on-time and within budget. You'll be interacting with design professionals who pride themselves on the highest level of integrity, dependability, ethics and quality of work.

We're also exceptionally innovative and responsive. Think of Bergmann as an extension of your organization and your trusted advisor.

Bergmann Associates is a full service, multi-disciplinary design firm employing some of the most talented practitioners in the industry. Our core business segments include Transportation Systems, Civil Works, Building Design, Land Development, Community Planning & Design and Program Services.

Bergmann Associates is very proud of our extensive experience and rich portfolio of work which features everything from restoration of historic landmarks to comprehensive bridge and highway design to waterfront master planning.

You'll be in good company at Bergmann. Our client list spans commercial, institutional, retail, educational, industrial and governmental sectors throughout the United States, all of whom come to us with unique requirements and challenges. We look forward to helping you with your project needs.

Please contact Vince Press for media inquiries:
vpress@bergmannpc.com // 585-232-5137 x250

Founded in 1980 by Don Bergmann Headquartered in Rochester, NY.
Employs more than 320 people company wide. Maintains 11 U.S. offices.



Akron, OH | Albany, NY | Buffalo, NY | Elmira, NY | Ft. Lauderdale, FL | Jacksonville, FL | Lansing, MI | Philadelphia, PA | Pittsburgh, PA | Rochester, NY | Syracuse, NY

DISCIPLINES:

- Architecture
- Interior Design
- Sustainable Building Design
- Civil Engineering
- Structural Engineering
- Mechanical Engineering
- Electrical Engineering
- Environmental Engineering
- Community Planning & Design
- Landscape Architecture
- Geospatial Services
- Construction Services
- Visualization / Virtual Design

CORE COMPETENCIES:

- Highway
- Bridge
- Railway Engineering
- Water Resources
- Navigation and Waterfront
- Retail Buildings
- Emergency Services Buildings
- Advanced Manuf. / Clean Buildings
- Colleges & Universities
- Community Planning & Design
- Land Development
- Landscape Architecture
- Energy Services

BUSINESS SEGMENTS:

- Buildings Group
- Civil Works Group
- Planning & Design
- Developmental Services
- Transportation Group

VALUES:

- Our People
- Service
- Teamwork
- Integrity & Ethics
- Excellence
- Sustainability

Leadership



Thomas Mitchell, PE

President & CEO
 585-232-5137 x370
 tmitchell@bergmannpc.com

Mr. Mitchell has 37 years of diverse engineering and construction experience. His career has been enriched with extensive involvement with field construction projects through assignments as field engineer, resident engineer, project engineer and project manager. He has served as a staff engineer on project design efforts and held various positions as a project engineer. He has been involved in the engineering and construction services field serving the utility and industrial markets. Throughout his career he has been involved with estimating, planning and scheduling of projects as a service to the engineer and owner's perspective.

Mr. Mitchell has directed large industrial and electric generating projects involving siting reviews, conceptual designs, feasibility studies, design development and production, equipment selection, plant start-up and test and operation assessment. He personally provides consulting services to clients for plant assessments, capital investment program evaluation, co-generation feasibility and plant life extension issues.

Transportation



Maria Lehman, PE, F.ASCE

Business Segment Director -Transportation
 716-852-3211 x863
 mlehman@bergmannpc.com

Ms. Lehman has over 30 years of multi-disciplinary experience in economic development; quality assurance; highway, transportation and facility planning, environmental assessment, design, management and construction monitoring as well as emergency management. Experience includes road reconstruction and widening design new highway; intersection and interchange geometric design; drainage design for roadway, rail, and building facilities; water and sewer lines, stream and lake hydraulics, hydrology, flood plain and flood control modeling and design; industrial rail sidings, permitting, site development, contract document preparation; corridor and site assessments, feasibility studies, transportation planning and right-of-way mapping.

Civil Works



William Miles, PE

Business Segment Director - Civil Works
 585-232-5137 x357
 bmiles@bergmannpc.com

Mr. Miles has over 37 years of experience in structural engineering for lock and dam, flood control, environmental, waterfront and shipyard and transportation projects. He has extensive experience with navigation and waterfront facilities including rehabilitation and restoration.

He served as Project Manager for numerous flood control and navigation projects for the US Army Corps of Engineers, NYS Thruway Authority Canals, and other State and Canal Authorities. He is an active member of ICRI, which is the nation's leading concrete repair organization.

Water Resources



Kenneth Avery, PE, CFM, D.WRE

Business Segment Leader - Water Resources
585-232-5137 x370
kavery@bergmannpc.com

Mr. Avery has 35 years of experience in environmental and water resources engineering for transportation projects and flood control. He has been the Lead Hydraulic Engineer for many NYSDOT and LAFAP projects, the NYSTA Bridge Scour Evaluation Program (western NY State), and the NYSTA Hydrologic and Hydraulic Engineering Term Services Agreement. He is experienced in the use of steady and unsteady flow models (HEC-RAS, HEC-HMS, SWMM, DYNLET), bridge hydraulics, HEC-18 and HEC-23 bridge scour guidelines, stream stability and river mechanics and design of riprap revetment.

Mr. Avery has conducted environmental assessments and hydraulic analyses for bridge projects for the Corps, NJDOT, PennDOT, the Pennsylvania Turnpike Commission and NYSDOT. Mr. Avery is a Certified Floodplain Manager.

Rail-Transit



Carmen Garozzo

Senior Rail Engineer
716-852-3211 x859
cgarozzo@bergmannpc.com

Mr. Garozzo has 33 years of diversified experience in the fields of Civil Engineering, Structural Engineering, Transportation Planning and Construction Management. Mr. Garozzo's experience includes railroad design and engineering; traffic signal planning and design and management of construction operations with a primary focus on highway and bridge transportation projects.

He has been involved in both design and construction projects from inception to completion. Mr. Garozzo's responsibilities at Bergmann include: design preparation, project management, construction cost estimating, report production, quality control, construction management, director of construction operations, and execution of traffic safety planning.

Bridge



David Thurnherr, PE

Business Segment Leader - Bridges
585-232-5137 x262
dthurnherr@bergmannpc.com

Mr. Thurnherr has 27 years of experience in structural engineering including the inspection, analysis and design of heavy industrial buildings and bridges. He has completed numerous projects involving, in-depth inspections, testing, analysis, conceptual design and preparation of Contract Documents for the rehabilitation of existing structures. In addition, he has extensive experience with projects which have involved the conceptual design and final design for new structures. He is well versed in numerous computer applications and leads development of Bergmann Associates Structural Software.

Mr. Thurnherr has experience in management of various types of building and bridge projects. He manages large multi-discipline projects with several different disciplines and sub consultants involved as well as pure structural projects.

Sustainability



Michelle Sommerman, PE, LEED AP

Mechanical Engineer/Sustainable Design Team Leader
585-232-5137 x390
msommerman@bergmannpc.com

Ms. Sommerman brings 14 years of experience in Mechanical Engineering for renovations and new construction including municipal, industrial, retail, emergency services and corporate office space.

She has designed HVAC systems (including piping/ductwork distribution, equipment sizing/selection), fire protection and plumbing piping systems. Ms. Sommerman and edited specifications for associated mechanical materials and equipment and provided construction support for associated projects (i.e., submittal review, RFI's). She is Bergmann's Sustainability Team Leader and serves as LEED Facilitator for many projects aiming for LEED Certification.

Land Development



Peter Giovenco, PE

Business Segment Director - Development Services
585-232-5137x412
pgiovenco@bergmannpc.com

Mr. Giovenco leads the Development Services Group at Bergmann Associates. This group of over 60 personnel consists of civil engineers, landscape architects, planners, GIS specialists, surveyors and entitlement/permitting specialists. He has built his career on leading complex and controversial projects and multi-project programs. This experience has exposed him to a wide array of project phases, ranging from site feasibility, design, and permitting to constructability. As a result, this has prepared him to successfully lead large multi-discipline teams through the encouragement of teamwork and communication. His skillful management of such a diverse group of professionals allows the Development Services Group to assist clients with any type and size of project.

Planning



Andrew Raus, AICP

Business Segment Leader - Planning + Design
585-232-5135 x495
araus@bergmannpc.com

Mr. Raus brings a diverse background of planning and municipal consulting to the firm throughout New York State especially within the Finger Lakes Region, the Erie Canal Corridor, the Capital District and western New York. His experience includes waterfront and downtown redevelopment planning, economic development, land use planning, transportation and environmental assessment.

One of the skills Mr. Raus masters is incorporating effective interpersonal skills in his design management of effective public participation. This skill has been critical to Bergmann's project success and planning expertise. He also demonstrates a unique talent for facilitating cooperation among competing interests and gaining support for multi-jurisdictional planning efforts.

Building Design



Andrew Petrosky, AIA

Business Segment Director - Buildings
 585-232-5137 x488
 apetrosky@bergmannpc.com

Mr. Petrosky is the leader of Bergmann Associates' Buildings Group. He has 19 years of architecture experience and has been with Bergmann Associates since 1995. Recent project experience includes multiple fire station replacements, additions, renovations, a volunteer ambulance facility addition and several needs, location, feasibility and concept studies throughout western New York. Mr. Petrosky responsibilities include client development, project management, design and construction document development. He also is experienced in programming, space planning, project estimating and construction administration. He has considerable experience assisting clients in understanding, defining, pursuing financing and jump starting their project.

Architecture



Thomas Castelein, AIA, LEED AP

Principal Architect
 585-232-5135 x358
 tcastelein@bergmannpc.com

Mr. Castelein has been practicing architecture for 25 years. His diverse work history has provided him with a broad range of professional experience. His most successful projects involved renovation or adaptive reuse of existing facilities, including working with sensitive landmark structures.

Mr. Castelein's portfolio includes working with retail, residential, commercial, and institutional clients with particular expertise within corporate/ commercial projects, retail banking, and childcare design. He has three years of experience in private practice as well as 19 years with Bergmann Associates.

3D Design / IDM



Charles Hixon III

Business Segment Leader - 3D Design + IDM
 585-232-5137 x368
 chixon@bergmannpc.com

Mr. Hixon is the founder and administrator of Bergmann Associates 3D Design + IDM group, a digital graphics division that specializes in the creation of high end, 3D digital computer modeling, animation and virtual design applications. He has over 18-years of experience in the planning, development and project management of the Visualization business unit.

Mr. Hixon has managed several award winning projects including a Smithsonian Institution Laureate for digital animation work on the nationally aired Public Broadcasting Corporation (PBS) documentary "Echoes from the Ancients".

Considered an expert on virtual reality applications for planning and design, Mr. Hixon authored a Synthesis Study titled "Visualization for Project Development" for the National Cooperative Highway Research Program (NCHRP). He is also a founding Board Member for the Transportation Research Board (TRB) Sub-Committee on Visualization.

**Architecture/
Historic Preservation**

James Durfee, AIA, LEED AP

Design Principal; Architecture
585-232-5137 x342
jdurfee@bergmannpc.com



Jim Durfee is recognized as an architect and community leader with over 30 years of experience in the profession. On a routine basis he has demonstrated an ability to negotiate challenging circumstances. An award winning designer, Mr. Durfee also has the management expertise to handle complex projects. He has extensive experience in historic rehabilitation and restoration. Working creatively with preservation guidelines, his projects transform neglected historic structures into substantial new community assets. Several of his projects have received awards from state preservation organizations. His commitment to direct staff and his personal involvement in projects is a hallmark of the firm's success. His design and management experience span a broad range of project types ranging from large-scale health care, municipal, and institutional projects, to smaller scale academic, commercial, and housing projects.

Mr. Durfee has developed an effective sense of the development and funding mechanisms that influence the design/construction projects with which he is involved. This broad awareness has proven valuable and optimizing results in achieving success with projects involving complex development and scheduling requirements.

Interior Design

Richard Napoli, AIA

Design Principal / Architect
585-232-5135 x486
rnapoli@bergmannpc.com



Mr. Napoli has over 25 years of experience in both Interior Design and Architecture. He has been responsible for the design and implementation of a multitude of projects including; corporate offices, college/university, commercial, industrial, laboratory, sound studios, food service and others.

He is typically involved in all aspects of a project including master planning, visioning, brand identity, programming, schematic design, design development, through final design. As a lead design architect, he is responsible for the complete coordination with the project team including: members of the client's team, sub-consultants, contractors, vendors, and in-house engineering staff.

Electrical

Case Smeenk, PE

Principal Electrical Engineer
585-232-5137 x266
csmeenk@bergmannpc.com



Mr. Smeenk has 24 years of experience as an electrical engineer and ten years experience as a journeyman electrician and instrumentation mechanic. He is experienced in medium voltage distribution, building power distribution, emergency and stand-by power generation, load centers, motor control centers and panel room design.

Mr. Smeenk is also experienced in lighting design, fire alarm systems, process control systems, tele/data distribution and power load flow. He is also a commercial and residential building inspector. Mr. Smeenk has completed Criterium's Professional Engineering Building Inspection training and has performed over 2500 building inspections.

Mechanical



David Porter, PE, LEED AP

Principal Mechanical Engineer
585-232-5137 x242
dporter@bergmannpc.com

Mr. Porter with over 26 years of experience has been involved in mechanical designs for many institutional, industrial and commercial projects. His level of participation has been as project manager, supervising engineer and as lead mechanical engineer with responsibility for all aspects of the mechanical design.

Energy



Charles Bertuch, PE, LEED AP

Regional Office Manager/Energy Business Segment Leader
315-422-5200 x761
cbertuch@bergmannpc.com

Mr. Bertuch is Bergmann's Syracuse Regional Office Manager and also serves as the lead Project Manager for the Energy / Sustainability practice. He has 27 years experience in energy and mechanical engineering for consultants and industry and is a certified Energy Manager, LEED Accredited Professional, and Professional Engineer.

Mr. Bertuch manages Bergmann's NYSERDA Flex-Tech program; the NYS Agricultural Energy Efficiency Program; over 50 commercial PV and wind energy projects; the NYS Biofuels Program; and energy performance contracting work throughout the US.

GIS



Jeffery Volpe, GISP

Geospatial Business Segment Manager
585-232-5137 x874
jvolpe@bergmannpc.com

Mr. Volpe has over 18 years experience with Geographic Information Systems (GIS) and is responsible for conducting and developing Needs Assessments, Business Plans, ROI strategies, GIS database design and development, data conversion and integration, spatial analysis and GIS programming/application development.

Mr. Volpe is also responsible for integrating Geospatial Services into other disciplines within Bergmann Associates including transportation planning, environmental, site development and virtual design projects.